



Paddock.

RESIDENT ART
 CAPTURING
 EXTRAORDINARY
 TERRITORY ART

Paul Arnold is leading the way with his creative Elevated range. A mixture of photography and digital art, the limited-edition range is entirely original and cannot be replicated. 'Paul's Rules' ensure the images are unique and reaffirm his ideals and values as an artist.



Slivered.

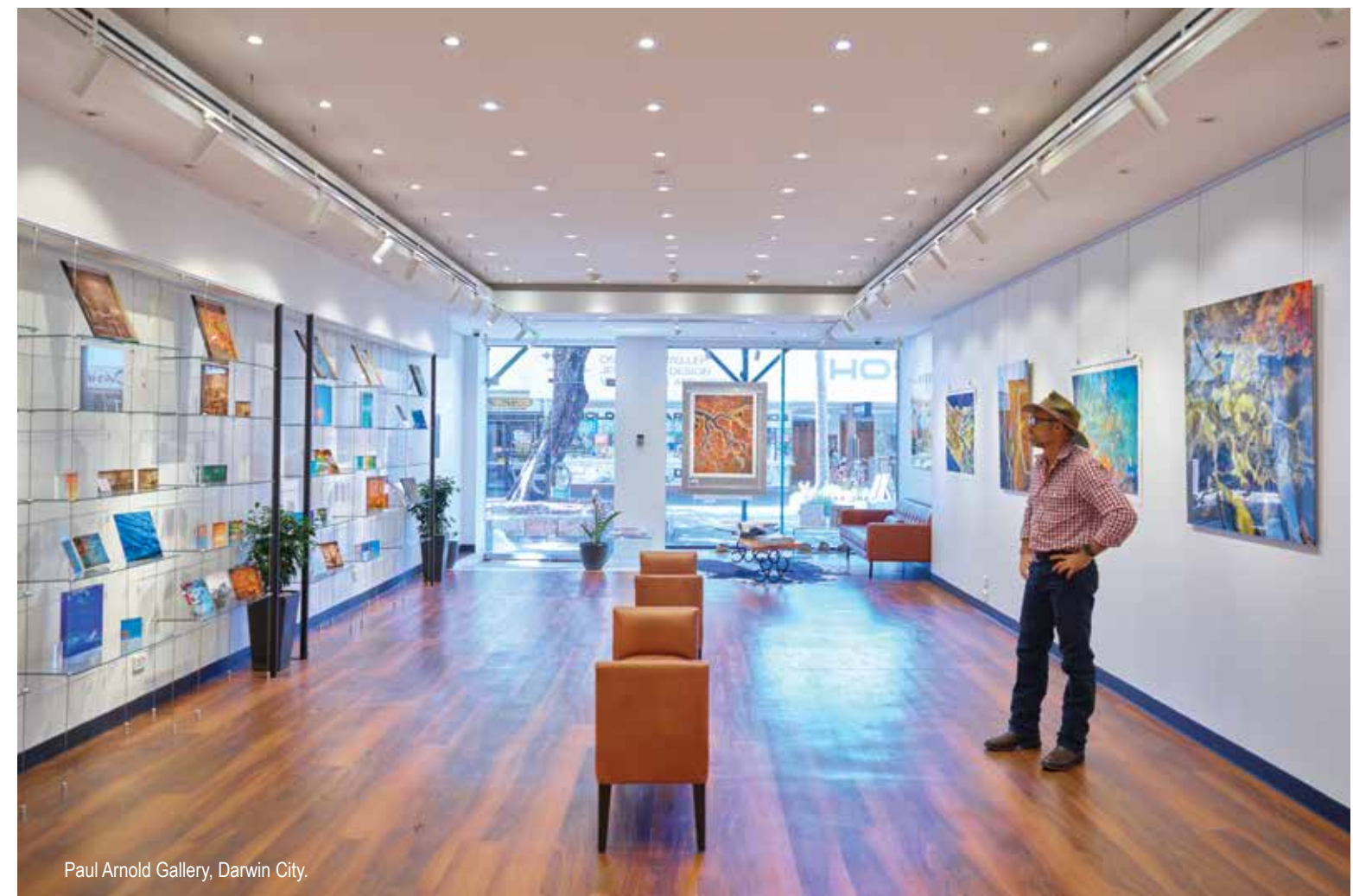

Paul Arnold Gallery, Darwin City.

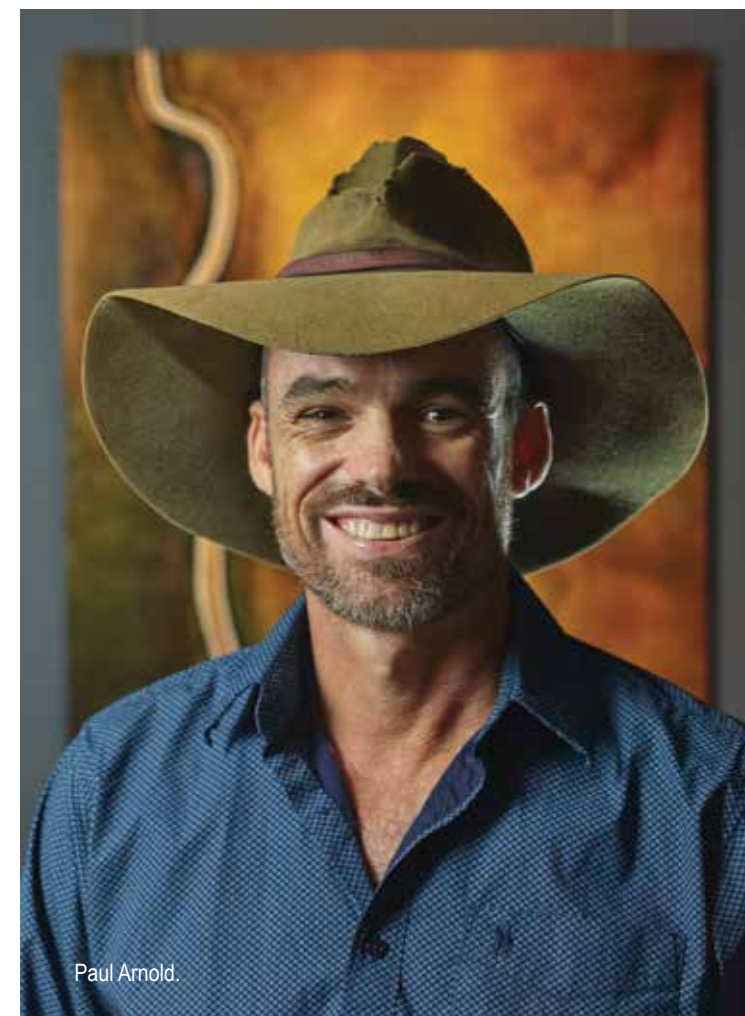

Paul Arnold.

'When you purchase a limited-edition Elevated art piece, it is truly limited. There is only a single original capture to create each individual piece. I do not combine images or copy settings from other images,' he says. 'All images are captured on a Phase One medium format camera – the world's most advanced camera system – and the landscape shape and forms are just as captured by the camera. Only 10 physical prints are released per artwork – one to seven immediately, eight, nine and 10 are reserved for the future. There are definitely no artist proofs or second editions.' To capture each image, Paul hangs out of an aircraft at an average of 8,000 feet or 2.5 kilometres with a \$100,000-plus camera in his hands. His Danish Phase One camera, purchased especially for creating his art, is certainly not for everyone. It comes in four components with the back alone costing \$70,000. But the 150-megapixel images and Capture One editing system allow him to weave his unbelievable, unique magic by pushing the system to its limits. 'Drones can only fly to 400 feet so they can't capture what I can with my Phase One. Normal photography creates a record; my aerial art is individual,' he says. A science graduate, Paul is a self-proclaimed Aussie bushman. He has crisscrossed our amazing continent working in mines and served as an Officer in the Royal Australian Navy. His passion for exploration has been at the core of his landscape photography since 2004 when he first exhibited his works at the Palmerston Markets. 'This new artwork is a running exhibition. I'm continually adding to it. It's been almost three years in the making and has been digitally challenging for me. I like to think I'm taking the gallery and de-commercialisation to the next level,' he says. In 2018, designer Camilla Franks walked into Paul's Gallery and chose two of his artworks to include in her 2019 Mother collection. 'Photography was a lone existence,' Paul says. 'Since becoming an artist I've collaborated with many other artists, it's been amazing.' Paul is continually adding to his shared experiences. His Nourlangie storm artwork on the Waterfront skywalk forms part of the new Bruce Munro Tropical Light display, and he designed the volunteer's uniforms. His remaining traditional landscape photography is still available for sale online.

To experience our unbelievable country in a different way, drop in to the Paul Arnold Gallery, open Mon-Fri 9am-5pm, Sat 9am-3pm, Shop 6, 27 The Mall, Smith Street, Darwin. Ph: 8941 6062 darwin@paularnold.com.au www.paularnold.com.au